



Smart Control Panel L Tec Spec

Table of contents

1. Product overview	3
2. Application field	3
3. Product Features	3
4. Product Specifications	4
5. Installation Guide	12
6. Packing List	12

1.Product Description

Smart Control Panel L adopts a 5–inch full touch screen, developed based on the Linux platform, supports the installation of mainstream 120–type bottom boxes, comes with two relays, can seamlessly replace the switch panel, and integrates Zigbee gateway and Alexa intelligent voice control functions at the same time. Users can control devices and scenes through various methods such as touch and voice, helping users manage smart devices and scenes at home quickly and conveniently. It is suitable for use in North America, Latin America, Japan and other regions.

2.Application field

- ◇Smart Home
- ◇Hotel
- ◇Community
- ◇Estate

3.Features

1、 Zigbee gateway

The integrated Zigbee gateway function can replace the Zigbee gateway at home, and has the edge capability of localized control.

Smart Control Panel L Tec Spec

2、 Alexa voice function

Built-in Alexa voice assistant, voice control of home devices, scenes and other voice skills.

3、 Device control

Rich device control entrances and diverse control forms, compatible with most Tuya ecological equipment.

4、 Scene control

Both screen interaction and voice interaction can trigger scenes to meet different needs in life.

5、 Easy to install

Neutral and live wire installation, the intelligent upgrade can be completed by using the standard 120 cassette.

6、 Simple configuration

Scan the code to log in, and the devices and scenes in the mobile app will be automatically synchronized to Smart Control Panel L.

4.Product specification

Smart Control Panel L Tec Spec

Basic Information	
Product number	OTPP05-Z
Product name	Smart Control Panel L
Picture (Front)	
Picture (Back)	
Input	100–240VAC,50/60Hz
Wireless protocol	Wi-Fi, Sigmesh (reserved), Zigbee
Operating temperature	0~40 °C
Working humidity	5%–90%RH (non-condensing)
Size	72 * 127 . 3 *10.5mm (without base)
	72 * 127 . 3 *36. 5 mm (including base)

Smart Control Panel L Tec Spec

Hardware specification			
Chip solution	Mainboard	Chip manufacturer	Rockchip
		Mainboard model	OTPP05-Z
		Main chip model	RK 3308B-S
		Main chip frequency	1.3GHz
		Main chip architecture	Quad-core ARM Cortex™-A35
	Power board	Manufacturers	Biyi
		Model	KP21824MSG
	Wi-Fi	Manufacturers	Realtek
		Model	RTL8733BS
		Type	Uplink 2.4GHz, 5GHz
	Zigbee	Manufacturers	OMNIA
		Model	ZS 13 S
		Type	Downlink Zigbee
	Storage	Flash	256MB
		DDR	256MB
interface	Power supply	Input	100 ~ 240 VAC(±10%), 50/60Hz ± 3Hz neutral line

Smart Control Panel L Tec Spec

Ethernet	Specification	1*100M RJ45
	type	Uplink
Screen	Size	5 inches
	Resolution	480* 854
	Type	Multi-touch capacitive screen, anti-fingerprint coating
Microphone	Number	2 mics
Speaker	Number	1
	Power	1.2W
Antenna	Number	3
	Type	Built-in shell antenna
485	Number	1
	Type	RS485 interface
Relay	Number	2
	Power	Single channel up to 200 W, total up to 400 W
Software function		
Operating system		Based on Linux kernel, self-developed OS
Login Method		Scan code to log in
Display function		Support theme、 screensaver、 off-screen and proximity wake-up, voice wake-up, touch wake-up
		Multiple sets of personalized themes and screensaver switching

Smart Control Panel L Tec Spec



The Home page displays weather, time, date, week, shortcut control, etc.



Device list、Scene list display

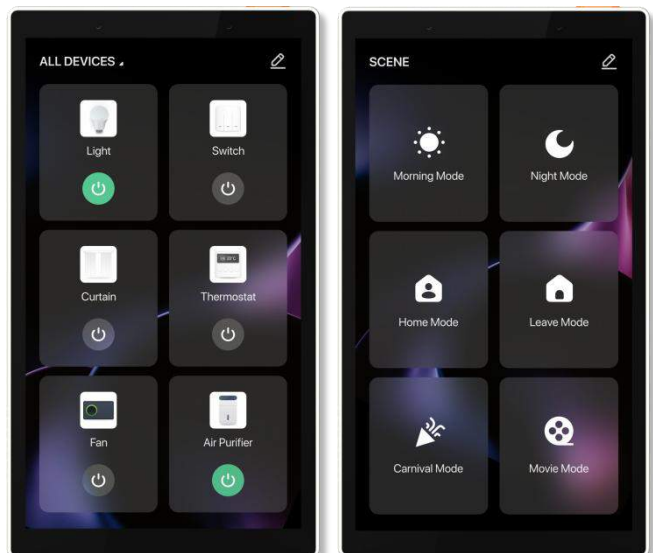

Interactive display on Quick Control

Smart Control Panel L Tec Spec

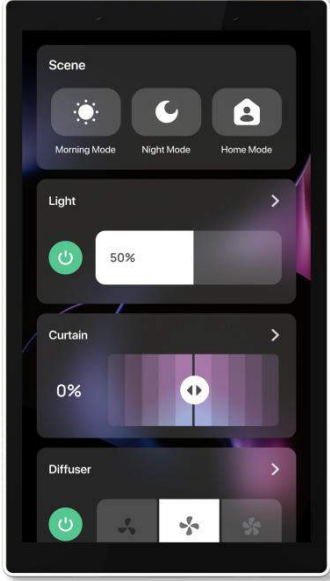
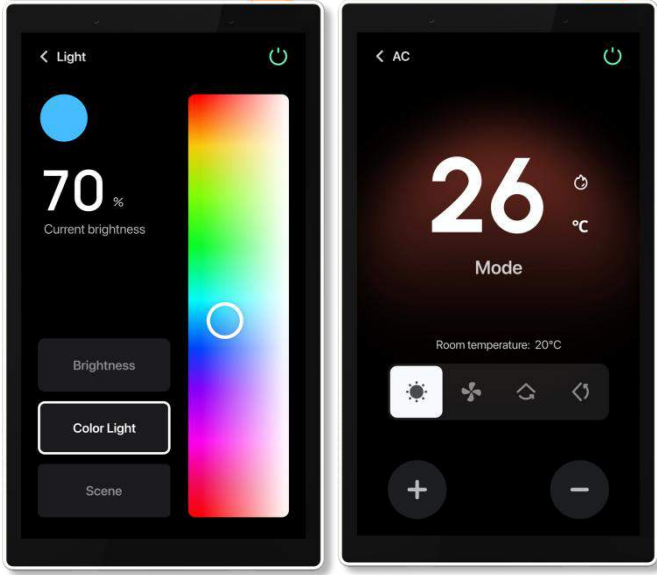
	
control function	Home shortcut control
	Device quick control
	Tap-to-Run
	Quick Control
	<p>Fine control of device</p> 
Please consult Tuya for the compatibility list of currently supported device categories	



Smart Control Panel L Tec Spec

Zigbee gateway function		More than 80 sub-devices that support Zigbee communication types are connected to the network
		Support remote access to logs
		Support OTA
		Support LAN equipment and scene control
		Support local linkage across gateways and communication protocols
Voice service	voice control	Alexa Built-in
	Speech skills	Device control, scene control, weather query, news query, etc.
set up	Network settings	WLAN settings、 Ethernet settings
	Sound	Mute setting, volume adjustment
		Multimedia call-in settings
	Display adjustment	Brightness manual and automatic adjustment settings
		Screen saver
		Do not disturb at night settings
	Device and System	System Upgrade
		Device restart
		Reset
		Clear cache

Smart Control Panel L Tec Spec

	Theme	Theme selection
	Language	Language selection
	Date and time	Local time zone, date, time display
	Screen saver	Screen saver selection
	Proximity sensing	Proximity switch
		Distance setting
	About	Device ID
		IP address
MAC address		
Working environment		
Operating temperature	0~40 °C	
Working humidity	5%~90%RH non-condensing	
Warranty	1 year warranty	

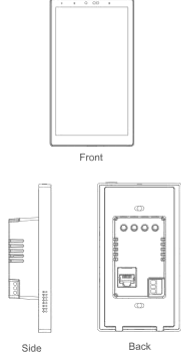
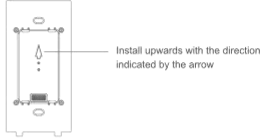
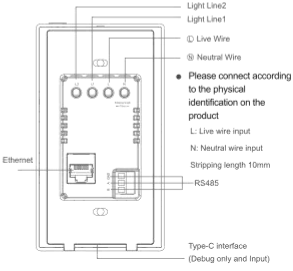
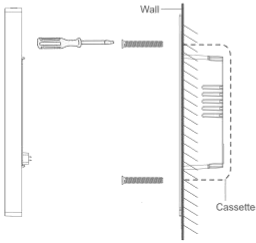
5. Installation guide

<p>Product description</p> <p>This in-wall Smart Control Panel L mainly provides gateway functions, interactive functions and scene panel functions. It is installed in the cassette of the user's home. The user can manage the sub-devices at home via interactive methods such as screens and apps.</p>  <p>Front Side Back</p>	<p>Product Installation</p> <p>Installation preparation</p> <ol style="list-style-type: none"> ① This product is powered by the neutral wire, please arrange the neutral wire in advance. ② This product is connected to the network through Wi-Fi or Ethernet, please arrange the Wi-Fi network or Ethernet cable in advance. ③ If you need to use the relay, RS485, security network port of this product, please preset the relevant cables in advance. ④ In order to ensure electricity safety and wireless performance, please use the standard plastic box for installation and use. ⑤ Please bring your own screwdriver, test pen, electrical tape and other tools, please do not operate with electricity. 	<p>Installation Instructions</p> <ul style="list-style-type: none"> • Turn off the main power switch, and use a test pen to confirm that the live wire in the cassette is not live. • Remove the panel (as shown below):  <p>Install upwards with the direction indicated by the arrow</p> <p>Wiring Instructions</p>  <ul style="list-style-type: none"> • Please connect according to the physical identification on the product L: Live wire input N: Neutral wire input Stripping length: 10mm RS485 Type-C interface (Debug only and input)
<ul style="list-style-type: none"> • Check the wiring to make sure that the copper wire is in good contact with the terminal and there is no exposed wire. • After fixing the base to the cassette with mounting screws, buckle back the panel. • Please note that the screws should not be tightened too tightly during the installation process to avoid deformation or damage to the screen or hardware. • If you encounter any problem with the installation, do not press too hard to force the installation. You should level the wall first and check the bracket.  <p>Wall Cassette</p>	<p>Quick Setup</p> <p>Download and open the app</p> <p>Search for "Smart Life" App in the App Store or scan the QR code on the outer packaging/instructions to download and install the App.</p> <p>For the first-time use, please click the "Register" button to register an account; if you already have an account, click the "Login" button.</p>  <p>Scan the QR code to download "Smart Life" App *App is subject to the actual released version</p>	<p>Commission settings</p> <ol style="list-style-type: none"> 1. Install the device according to the installation guide. Turn on the power, and wait for the device to initiate. Connect to the network according to the instructions on the screen. 2. Open the Smart Life App, then scan the QR code on the device to configure the network (as shown in the figure below), and perform related operations according to the instructions on the device interface after the commission is successfully finished.  <p>*The QR code is based on the display of actual device</p>

6. Packing list

Smart Control Panel L x1

Screw x 2

Card pin x1

Manual x1

Version update record

Seri al num ber	Updated	Update content	Updated version
1	20 2 3 – 08 – 10	first edition	V1.0.0